

ENZI HEIGHTS APARTMENT

| BLOCK A(facing Sapphire Apts) | | | | | | | | | |
|--------------------------------------|-----------|-----------|-----------|-----------|-----------|-----------|-----------|-----------|-----------|
| Offplan price | 12.95M | 12.95M | 6.95M | 6.95M | 6.95M | 6.95M | 6.95M | 9.95M | 9.95M |
| Unit size | 128sqm | 128sqm | 65sqm | 65sqm | 65sqm | 65sqm | 65sqm | 90sqm | 90sqm |
| Type of units | 3bed | 3bed | 1bed | 1bed | 1bed | 1bed | 1bed | 2bed | 2bed |
| Unit no.per floor | A1 | A2 | A3 | A4 | A5 | A6 | A7 | A8 | A9 |
| 12th | A-12-01 | A-12-02 | A-12-03 | A-12-04 | A-12-05 | A-12-06 | A-12-07 | A-12-08 | A-12-09 |
| 11th | A-11-01 | A-11-02 | A-11-03 | A-11-04 | A-11-05 | A-11-06 | A-11-07 | A-11-08 | A-11-09 |
| 10th | A-10-01 | A-10-02 | A-10-03 | A-10-04 | A-10-05 | A-10-06 | A-10-07 | A-10-08 | A-10-09 |
| 9th | A-09-01 | A-09-02 | A-09-03 | A-09-04 | A-09-05 | A-09-06 | A-09-07 | A-09-08 | A-09-09 |
| 8th | A-08-01 | A-08-02 | A-08-03 | A-08-04 | A-08-05 | A-08-06 | A-08-07 | A-08-08 | A-08-09 |
| 7th | A-07-01 | A-07-02 | A-07-03 | A-07-04 | A-07-05 | A-07-06 | A-07-07 | A-07-08 | A-07-09 |
| 6th | A-06-01 | A-06-02 | A-06-03 | A-06-04 | A-06-05 | A-06-06 | A-06-07 | A-06-08 | A-06-09 |
| 5th | A-05-01 | A-05-02 | A-05-03 | A-05-04 | A-05-05 | A-05-06 | A-05-07 | A-05-08 | A-05-09 |
| 4th | A-04-01 | A-04-02 | A-04-03 | A-04-04 | A-04-05 | A-04-06 | A-04-07 | A-04-08 | A-04-09 |
| 3rd | A-03-01 | A-03-02 | A-03-03 | A-03-04 | A-03-05 | A-03-06 | A-03-07 | A-03-08 | A-03-09 |
| 2nd | A-02-01 | A-02-02 | A-02-03 | A-02-04 | A-02-05 | A-02-06 | A-02-07 | A-02-08 | A-02-09 |
| 1st | A-01-01 | A-01-02 | A-01-03 | A-01-04 | A-01-05 | A-01-06 | A-01-07 | A-01-08 | A-01-09 |
| Ground Floor | | | | | | | | | |
| 1 st Basement Floor | | | | | | | | | |



Booked



Sold out

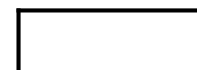

Available

ENZI HEIGHTS APARTMENT

| BLOCK B (Facing Mombasa road) | | | | | | | | | |
|--------------------------------------|---------------|---------------|---------------|---------------|---------------|---------------|---------------|---------------|---------------|
| Offplan price | 12.95M | 12.95M | 6.95M | 6.95M | 6.95M | 6.95M | 6.95M | 9.95M | 9.95M |
| Unit size | 128sqm | 128sqm | 65sqm | 65sqm | 65sqm | 65sqm | 65sqm | 90sqm | 90sqm |
| Type of units | 3bed | 3bed | 1bed | 1bed | 1bed | 1bed | 1bed | 2bed | 2bed |
| Unit no.per floor | unit 1 | unit 2 | unit 3 | unit 4 | unit 5 | unit 6 | unit 7 | unit 8 | unit 9 |
| 12th | B-12-01 | B-12-02 | B-12-03 | B-12-04 | B-12-05 | B-12-06 | B-12-07 | B-12-08 | B-12-09 |
| 11th | B-11-01 | B-11-02 | B-11-03 | B-11-04 | B-11-05 | B-11-06 | B-11-07 | B-11-08 | B-11-09 |
| 10th | B-10-01 | B-10-02 | B-10-03 | B-10-04 | B-10-05 | B-10-06 | B-10-07 | B-10-08 | B-10-09 |
| 9th | B-09-01 | B-09-02 | B-09-03 | B-09-04 | B-09-05 | B-09-06 | B-09-07 | B-09-08 | B-09-09 |
| 8th | B-08-01 | B-08-02 | B-08-03 | B-08-04 | B-08-05 | B-08-06 | B-08-07 | B-08-08 | B-08-09 |
| 7th | B-07-01 | B-07-02 | B-07-03 | B-07-04 | B-07-05 | B-07-06 | B-07-07 | B-07-08 | B-07-09 |
| 6th | B-06-01 | B-06-02 | B-06-03 | B-06-04 | B-06-05 | B-06-06 | B-06-07 | B-06-08 | B-06-09 |
| 5th | B-05-01 | B-05-02 | B-05-03 | B-05-04 | B-05-05 | B-05-06 | B-05-07 | B-05-08 | B-05-09 |
| 4th | B-04-01 | B-04-02 | B-04-03 | B-04-04 | B-04-05 | B-04-06 | B-04-07 | B-04-08 | B-04-09 |
| 3rd | B-03-01 | B-03-02 | B-03-03 | B-03-04 | B-03-05 | B-03-06 | B-03-07 | B-03-08 | B-03-09 |
| 2nd | B-02-01 | B-02-02 | B-02-03 | B-02-04 | B-02-05 | B-02-06 | B-02-07 | B-02-08 | B-02-09 |
| 1st | B-01-01 | B-01-02 | B-01-03 | B-01-04 | B-01-05 | B-01-06 | B-01-07 | B-01-08 | B-01-09 |
| Ground Floor | | | | | | | | | |
| 1 st Basement Floor | | | | | | | | | |



Booked



Sold out

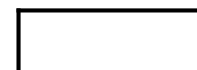

Avaiable

Fuxin Engineering Limited - Apartments on LR NO.209/18648 off mombasa road (Date:1-April-2019)

ENZI HEIGHTS APARTMENTS (BLOCKS A & B)

| Amenities | | |
|------------------|--|--|
| Function | Fully Equipped Gym | Lobby With Four Elevators |
| | Children's Play Area | 24Hr Security,Manned Gate & Electric fencing |
| | Swimming Pool | *Automatic Water Supply System |
| | Backup Generator | Ample Parking |
| | Solar/Electric High Pressure Water Supply System | Internet and Cable TV Connectivity |
| | *24 hrs Supply of Hot & Cold Water | Water Borehole |
| | Intercom Communication | Cctv Monitoring and Access Control |

| Payment Plan (Million) | | | | |
|-------------------------------|---------------------------|------------------|------------------|------------------|
| Type of Unit | | 3 bedroom | 2 bedroom | 1 bedroom |
| Apartment Buying Price | | 12.95m | 9.95m | 6.95m |
| 1 | Deposit Payment-20% | 2.59m | 1.99m | 1.39m |
| 2 | Quarterly installment-20% | 2.59m | 1.99m | 1.39m |
| 3 | Quarterly installment-20% | 2.59m | 1.99m | 1.39m |
| 4 | Quarterly installment-20% | 2.59m | 1.99m | 1.39m |
| 5 | Quarterly installment-20% | 2.59m | 1.99m | 1.39m |
| Totals | | 12.95m | 9.95m | 6.95m |

NOTE:

a) **Good discount applicable to fully paid cash buyers
Payment exclusive of Stamp duty, legal fees, and other costs**

b) **Service Charge Applicable per Month**

| | | |
|--------------------|--------------|-----------------|
| i One Bed Room | Kshs. | 5,000.00 |
| ii Two Bed Room | Kshs. | 7,000.00 |
| iii Three Bed Room | Kshs. | 9,000.00 |

Apartment

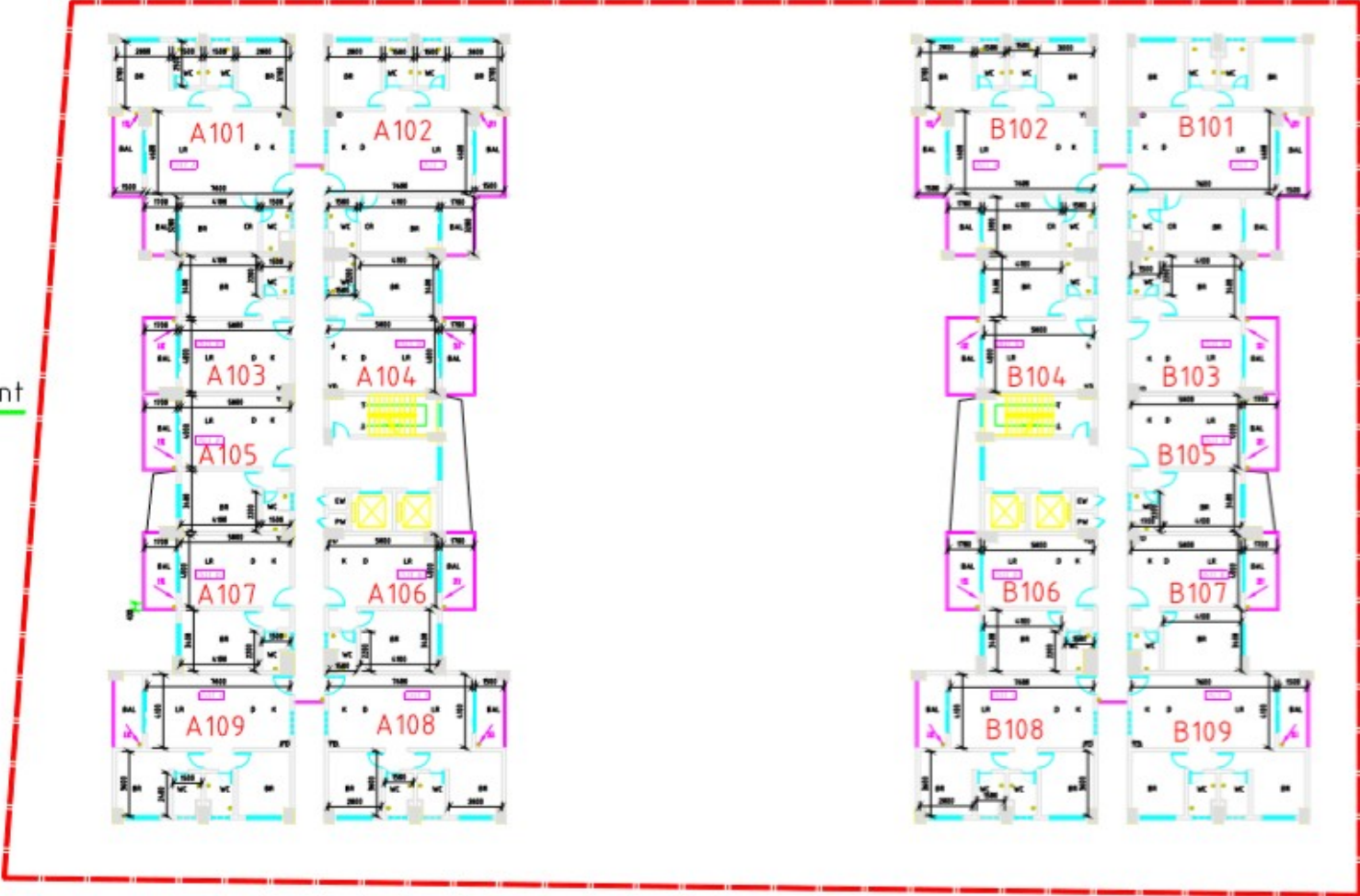

Next gen mall